

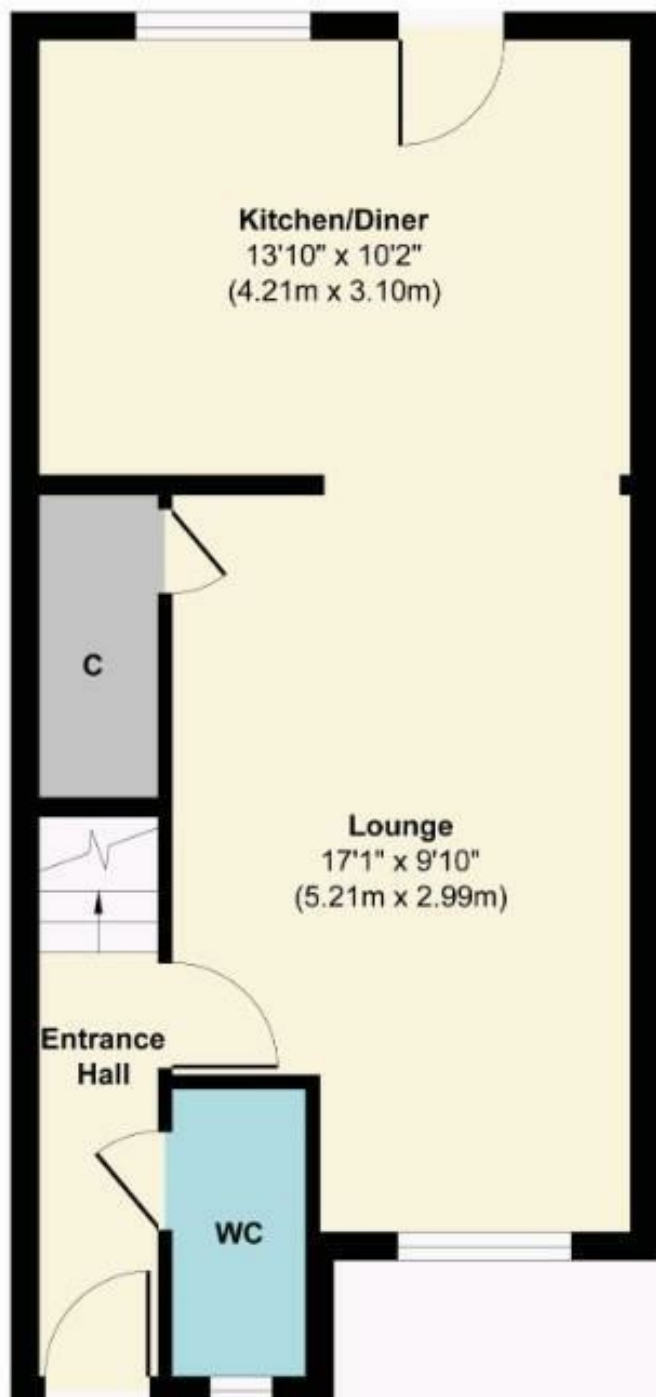

Aldermann McGee Gardens | Great Yarmouth | NR30  
 Guide Price £180,000

abbotFox



Ground Floor

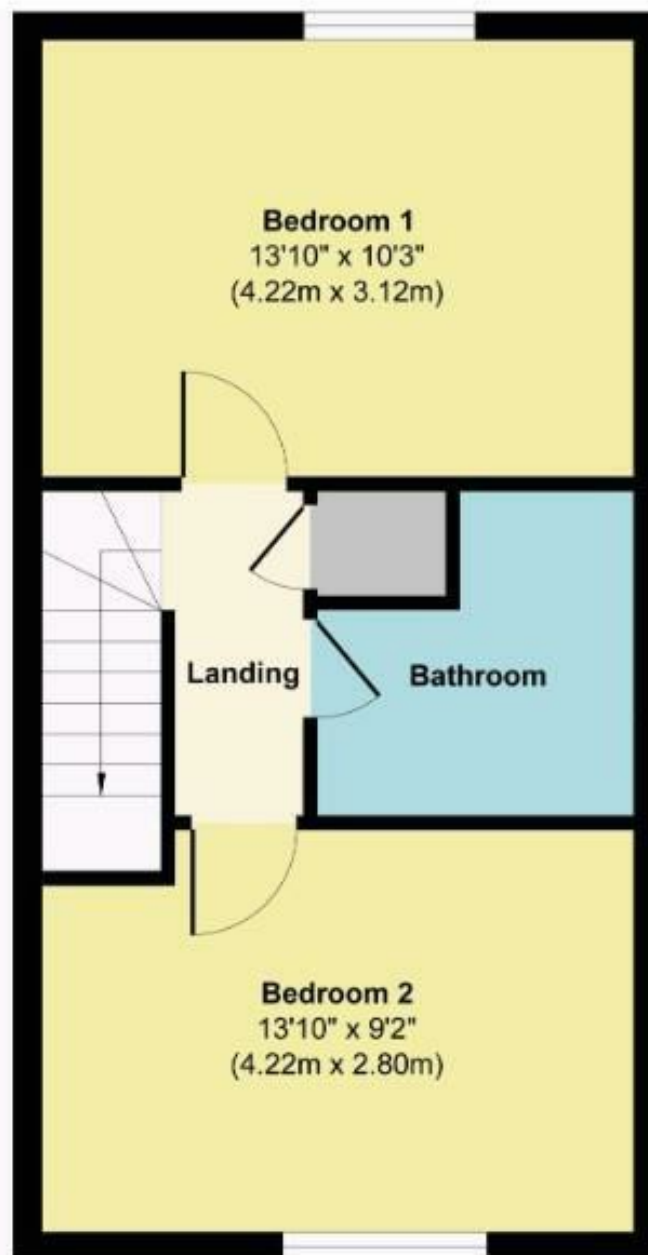

First Floor

Energy Efficiency Rating		Current	Potential
Very energy efficient - lower running costs			
(92 plus) <b>A</b>			
(81-91) <b>B</b>			
(69-80) <b>C</b>			
(55-68) <b>D</b>			
(39-54) <b>E</b>			
(21-38) <b>F</b>			
(1-20) <b>G</b>			
Not energy efficient - higher running costs			
<b>England &amp; Wales</b>		EU Directive 2002/91/EC	

Disclaimer – In accordance with the Property Misdescriptions Act, the company gives notice that all descriptions, references to condition, necessary permissions for use and other details are given in good faith and believed to be correct, but any intending lessees do not rely on them as statements of fact, but must satisfy themselves by inspection or other means, as to their accuracy.



abbotFox Land & New Homes presents this brand new, two bedroom end-terraced home, built by the renowned local builders G&C Homes.

Located in Great Yarmouth, this property is ideally situated for those looking to enjoy a vibrant coastal town with a rich history and culture. The town offers a wide range of amenities, including shops, restaurants, bars, and entertainment options. The property itself offers two double bedrooms and a family bathroom to the first floor, with an inviting entrance hall, wc, generous lounge and stylish kitchen diner to the ground floor. To the front the property allows for parking for two vehicles, with the property also offering an enclosed rear garden. An internal viewing comes highly recommended.

Agents Note: Please be aware the images are taken from a previous development of the same house type

